

Configuração etiqueta térmica

Impressora L42 PRO FULL

1. Configuração da impressora

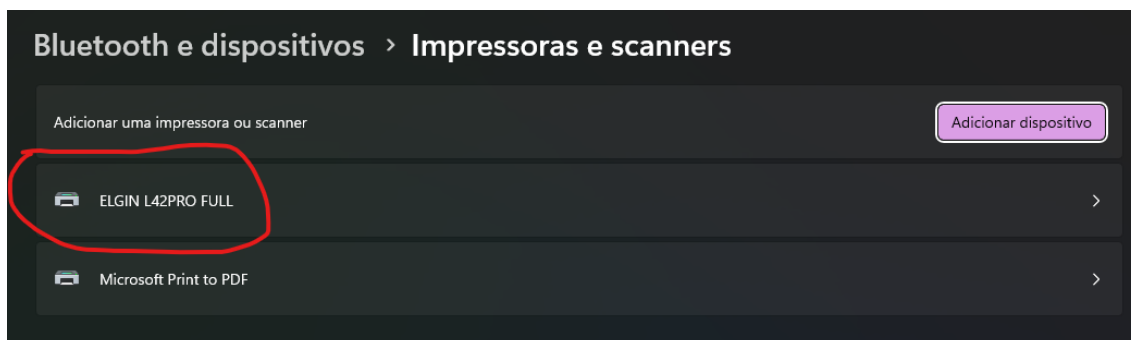

2. Propriedades da impressora

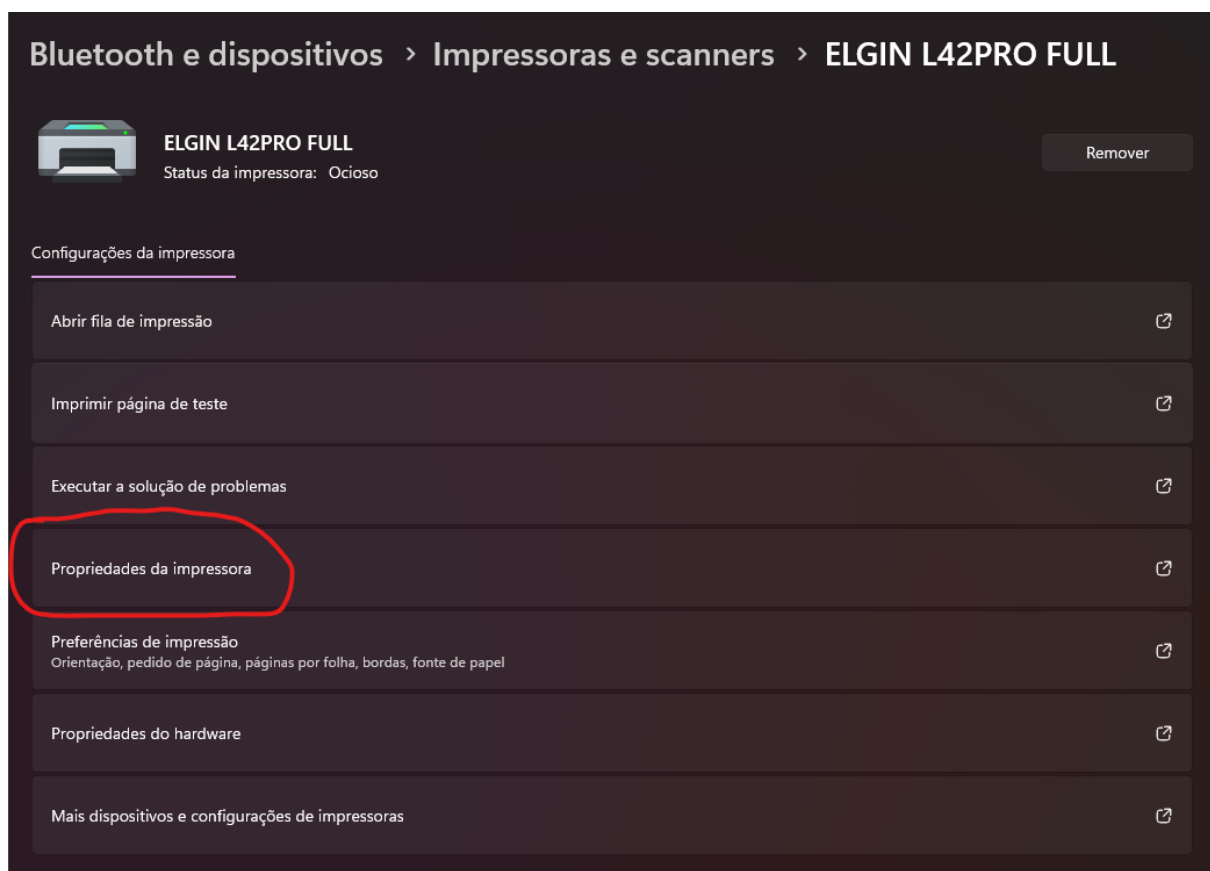

3. Preferências da impressora

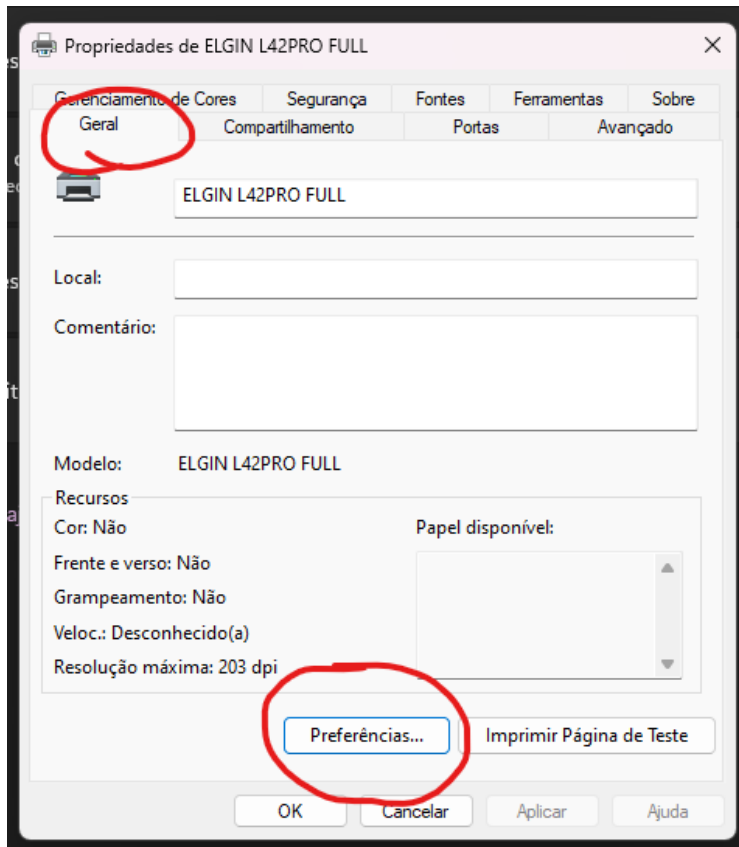

4. Criar papel de etiqueta

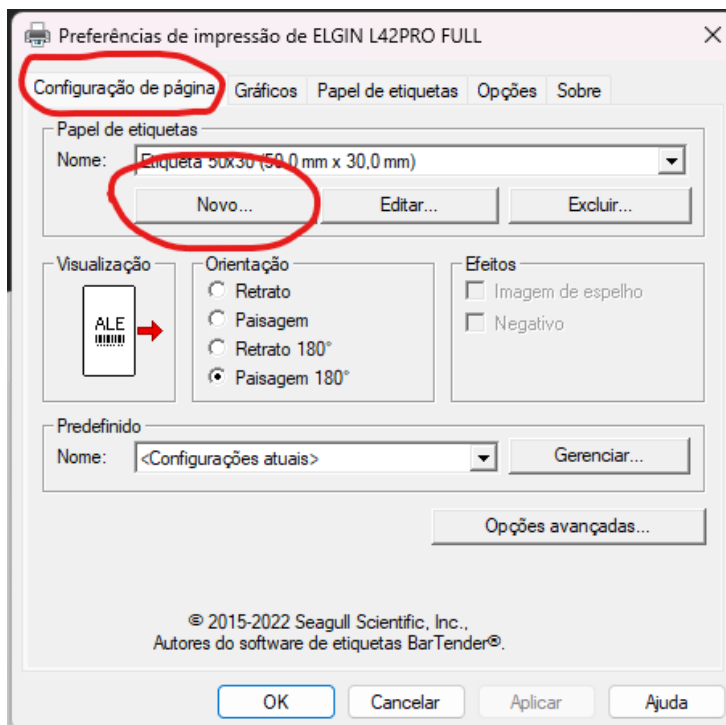

5. Definir um nome e largura e altura da etiqueta (50x30mm)

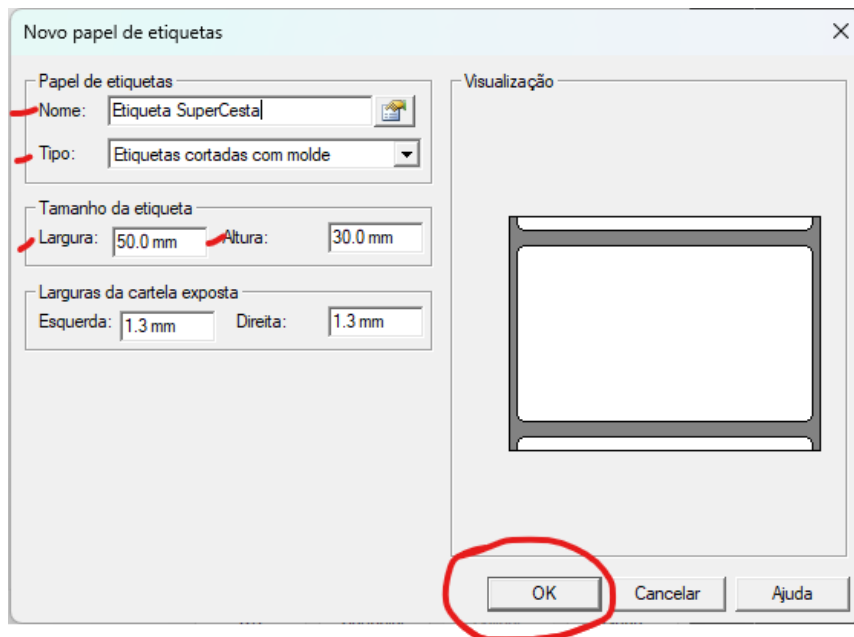

6. Definir gráfico

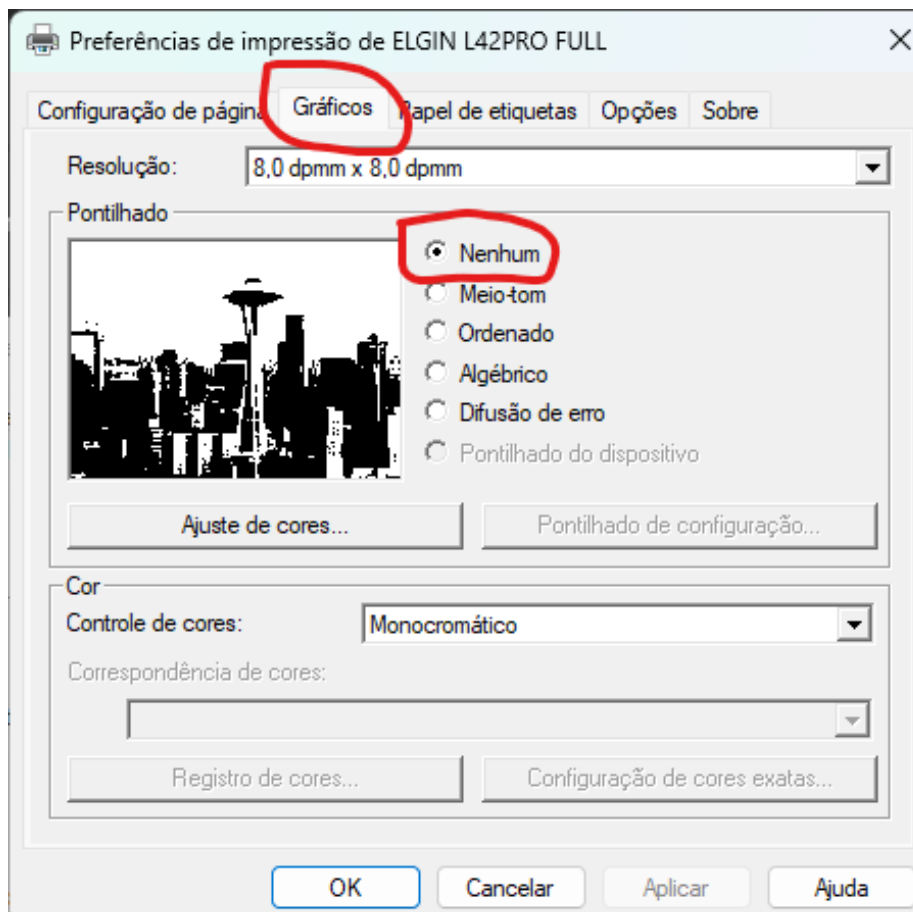

7. Definir no formato Paisagem

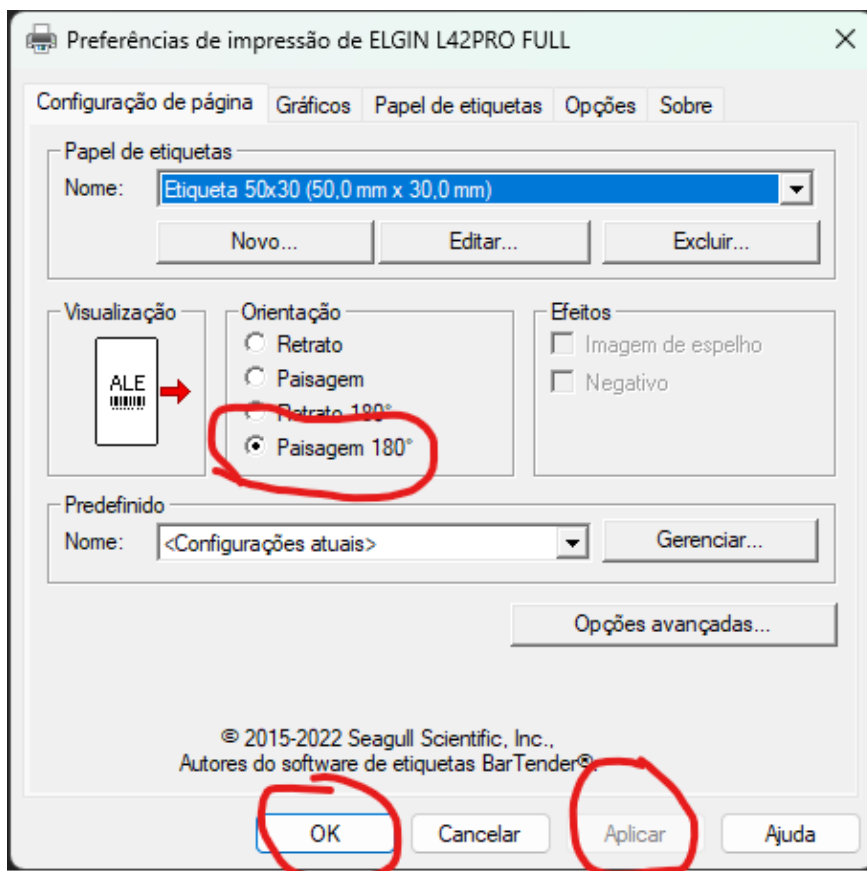

8. Finalmente, definir o tamanho do papel criado anteriormente e imprimir

